

7CBT06 7CBTY06



MAIN VEHICLE SPECIFICATIONS

| | | | | |
|---|--------------------------------------|------------|---------------------------------|---|
| Manufacturer | | | TOYOTA | TOYOTA |
| Model | | | 7CBT06 | 7CBTY06 |
| Power Type | | | Battery | Battery |
| Operator Position | | | Sit-down | Stand-up |
| Tire Type | Front/Rear | | Pneumatic/Pneumatic | Pneumatic-shaped Cushion Tire/ Pneumatic |
| Wheels (x = driven) | Front/Rear | | 1/2x | 1/2x |
| Maximum Drawbar Pull | 3-Minute Ratings | N <kg> | 450 <45> | 450 <45> |
| Rated Drawbar Pull (Towing Capacity) | 60-Minute Ratings | N <kg> | 150 <15> | 150 <15> |
| Towed Weight | 60-Minute Ratings | kg | 600 | 600 |
| Travel Speeds | No Load | km/h | 8.5 | 8.5 |
| | w/ Load | km/h | 7.5 | 7.5 |
| Gradeability * | 3-Minute Ratings | No Load | % (tanθ) | 17 |
| | | w/ Hitch | mm | 1460 |
| Overall Length | | w/o Hitch | mm | 1505 |
| | | | | 1370 |
| Front Overhang | | mm | 195 | 240 |
| Rear Overhang | | mm | 225 | 225 |
| Hitch Length | | mm | 90 | 90 |
| Overall Width | | mm | 745 | 745 |
| Overall Height | | mm | 995 | 1195 |
| Turning Radius (Outside) | | mm | 1480 | 1510 |
| Height of Hitch | | mm | 260 | 260 |
| Wheelbase | | mm | 950 | 950 |
| | | | | |
| Tread | Front | mm | — | — |
| | Rear | mm | 590 | 590 |
| Underclearance | Center of Wheelbase | mm | 65 | 65 |
| Floor Height | | mm | 140 | 135 |
| Total Weight | w/ Battery | kg | 200 | 220 |
| | Without Battery | kg | 130 | 150 |
| Weight Distribution (With STD Battery) | Front | kg | 60 | 70 |
| | Rear | kg | 140 | 150 |
| Tires | Number | Front/Rear | 1/2 | 1/2 |
| | Size | Front | 2.50-4-6PR (I) | 3.00-5 |
| | | Rear | 3.50-5-6PR (I) | 3.50-5-6PR (I) |
| Brake | Service (Hand) | | Mechanical | Mechanical |
| | Parking (Hand) | | Mechanical | Mechanical |
| Battery | Voltage/Capacity (5-Hour Ratings) | STD | V/AH | 24/100 |
| | Weight (STD Capacity Type) | | kg | 70 |
| Electric Motor | Drive | kW | DC 0.4 | DC 0.4 |
| Control Type | Drive | | Field Effect Transistor Chopper | Field Effect Transistor Chopper |

NOTE: * Computed values.



Pergudangan Lautan Jaya Kumala, Jl. Inspeksi Kalimantan KM. 22 Blok A
Gudang A-01, Cibuntu, Bekasi-17520

Telp : (021) 89535873
Mobile : 0817-0555-969
Email : thubastunggalperkasa@gmail.com
Website : www.thubastunggalperkasa.co.id

DIMENSIONAL DRAWINGS

7CBT06

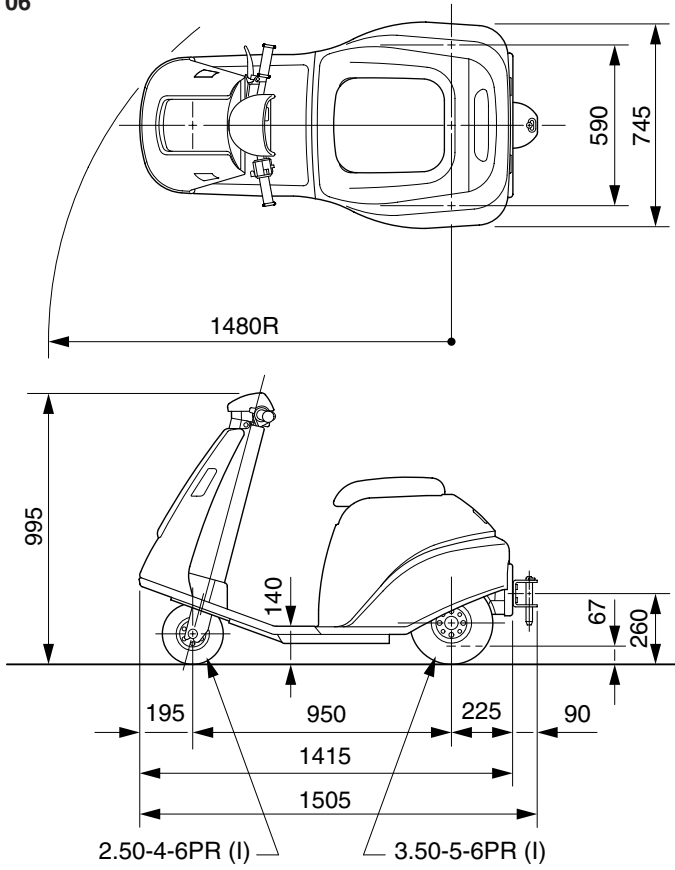

7CBTY06

